



VTD-MD2T7CH

2.1 Megapixel HD-TVI/CVBS
Mini Dome Camera with
2.9mm Fixed Lens



FEATURES:

- 1/3" 2.1 MegaPixel Progressive Scan CMOS Sensor
- HD-TVI & CVBS Video Output
- 2.9mm Lens Included (8 and 16mm also available)
- Digital Wide Dynamic Range (D-WDR)
- 2D-DNR - Two Dimensional Motion Adaptive Noise Reduction
- Detachable External OSD Joystick Controller
- Advanced OSD Functions: BLC/HLC, D-WDR, Motion detection, Privacy mask, Flip, DeFog
- Over 1500' HD Video Transmission (Depending on cable characteristics and integrity)
- Can be Semi-Flush or Surface Mounted
- IP-66 Rated Weather Resistant Aluminum Enclosure w/ Polished Chrome Finish
- 12VDC Operation



VITEK

INSTALLATION

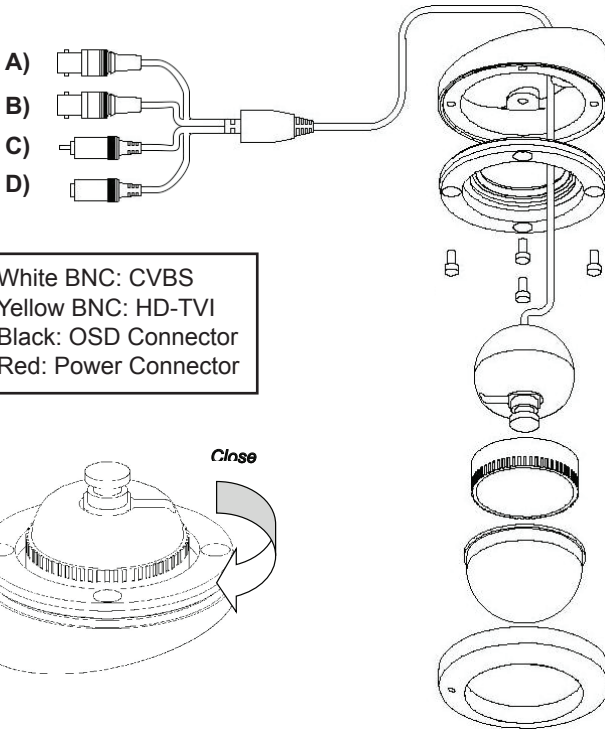

- A) White BNC: CVBS
- B) Yellow BNC: HD-TVI
- C) Black: OSD Connector
- D) Red: Power Connector

- 1) Align the camera unit with the surface of the ceiling, make marks on the ceiling in the places where the screw holes are to be drilled, and then drill the three holes.
- 2) Cut a hole (diameter:50mm) in the ceiling for routing the cables.
- 3) Pass the power cables from the camera unit through the cable hole in the ceiling.
- 4) Align the three screw holes in the camera unit with the screw holes in the ceiling, and then secure the camera in place by tightening the three tapping screws.
- 5) Use the supplied four screws to secure the middle base to the bottom base.
- 6) Tighten the guide ring, then adjust the camera.
- 7) Attach the bubble to the middle base.
- 8) Attach the top cover to the middle base.
- 9) Use the supplied star-shaded L-wrench to tighten the set screw on the top cover.

OSD MENU

- The setup menu can be accessed and controlled by the Detachable External OSD control joy stick.

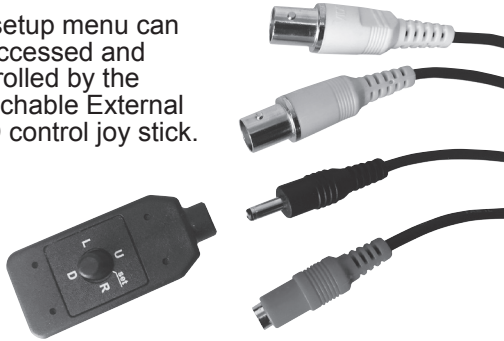

SELECTION	OPTIONS
LENS	MANUAL DC
FOCUS ADJ	ON/OFF
EXPOSURE	BRIGHTNESS SHUTTER TCS SENS-UP AGC
BACKLIGHT	WDR BLC HLC
DAY & NIGHT	AUTO EXTERN B&W COLOR
WHITE BAL	AWB MANUAL PRESET AUTOEXT
DNR	OFF LOW MIDDLE HIGH
IMAGE	SHARPNESS GAMMA MIRROR FLIP ACE DEFOG PRIVACY
MOTION	DET WIN DET TONE MDRECT SEN MOTION OSD TEXT SIG OUT
OPTION	COM IMAGE RANGE COLOR FRAME FREQ TVI COLOR BAR LANGUAGE CAM TITLE VERSION

SPECIFICATIONS

VTD-MD2T7CH

Imaging Sensor	1/3" Progressive Scan CMOS Sensor
Video Output	HD-TVI by BNC - CVBS by BNC
Resolution	2.1 MegaPixel (1920p x 1080p)
Effective Pixels	1920(H) x 1080(V) x 30p
S/N Ratio	More than 39.9dB (AGC Off)
Sensitivity	0.1 Lux
Lens Type	2.9mm Lens Included (8 and 16mm also available)
DAY / NIGHT	Auto
White Balance	Auto
DNR	2D-DNR
Advanced OSD Features	BLC/HLC, D-WDR, Motion detection, Privacy mask, Flip, DeFog
Weather Resistance Rating	IP-66
Operating Conditions	14° ~ 122°F (-10° ~ +50°C) < 80% RH
Input Voltage	12VDC
Power Consumption (12VDC)	100mA
Weight	14.11 Oz. (400g)
Dimensions (W x H x L)	3.15" x 1.69"/2.47" (80mm x 42.8mm/62.8mm)

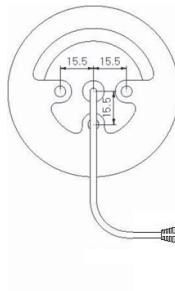
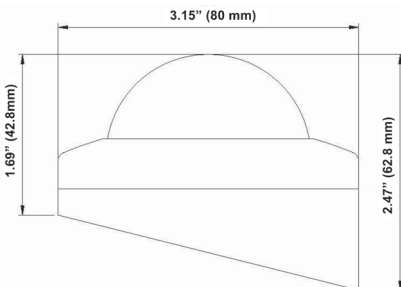

- A) White BNC:** CVBS
- B) Yellow BNC:** HD-TVI
- C) Black:** OSD Connector
- D) Red:** Power Connector

